

## VALVE BLOCK AIR LINE DIAGRAMS

### 1 AIR LINE DIAGRAM FOR: 2003-2010 PORSCHE CAYENNE (9PA)

VEHICLES MAY HAVE MARKED PLATE/BRACKET SHOWING LOCATION OF COLORED AIR LINES.

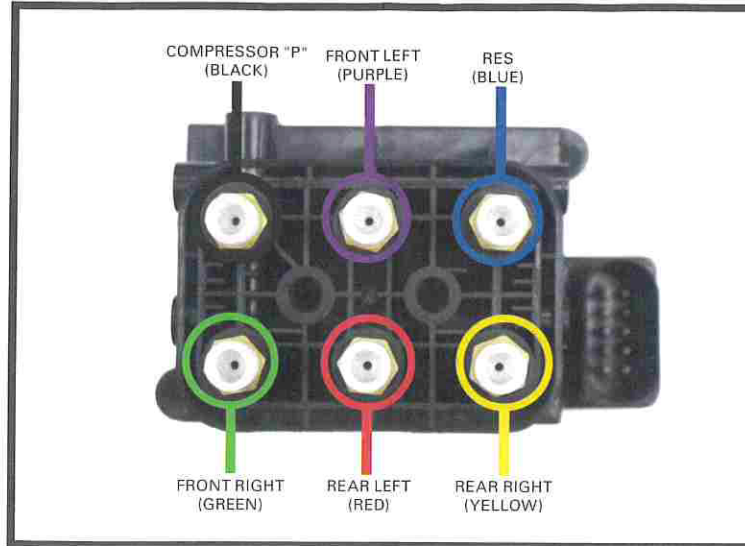

FIGURE 2

### 2 AIR LINE DIAGRAM FOR: 2010-2016 PORSCHE PANAMERA (970) EXCL. HYBRID 2011-2018 PORSCHE CAYENNE (92A) (FIGURE 3)

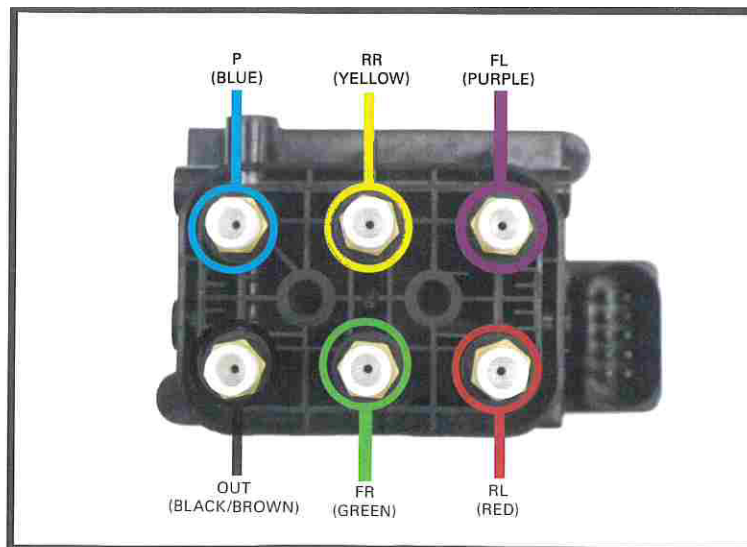

FIGURE 3

# DO NOT REMOVE OR TIGHTEN AIR FITTING ON THE NEW PART



## REMOVAL



Prior to inserting the existing air line into the new air fitting you will need to remove the old original equipment air line fitting.

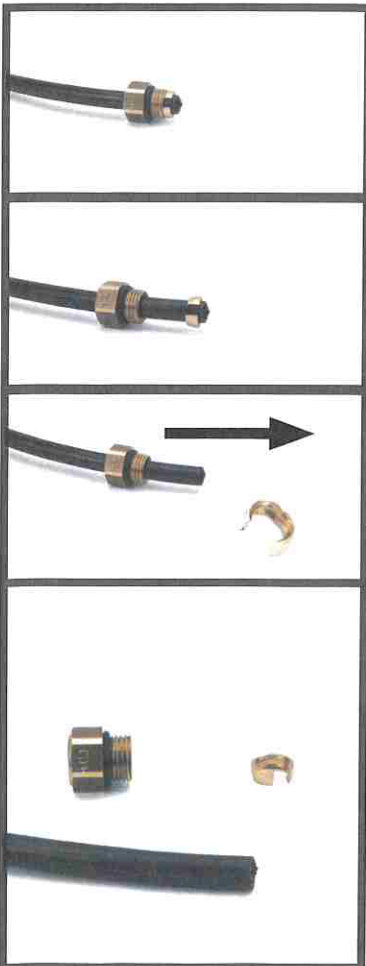

#1  
OE AIR LINE FITTING

#2  
SLIDE THE THREADED PORTION UP THE LINE AND SPREAD THE COLLET OPEN TO REMOVE

#3  
SLIDE THE AIR FITTING OFF OF THE AIR LINE

#4  
AIR LINE IS READY FOR INSTALLATION

**NOTE:** SCRATCHES AND/OR DEEP CUTS IN THE AIR LINE CAN RESULT IN POSSIBLE LEAKS. INSPECT THE AIR LINE BEFORE INSERTION. AIR LINE NEEDS TO BE REPLACED IF DAMAGED.

## INSTALLATION



Parts come with pre-installed air line fittings for your convenience. **Do not remove or tighten.**

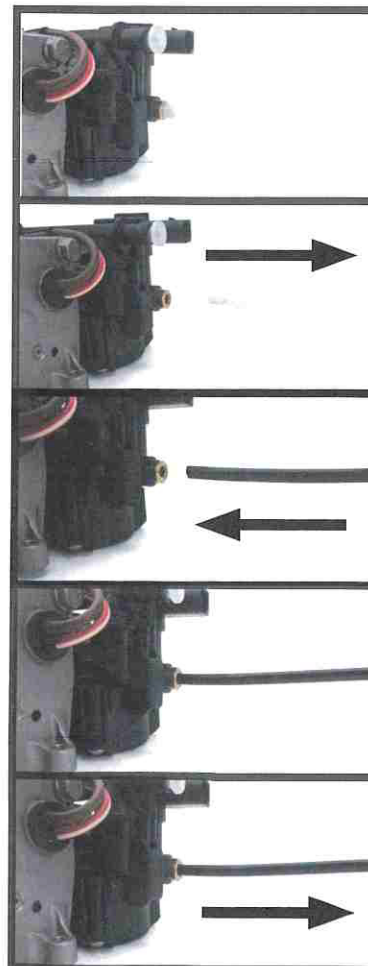

#1  
AS RECEIVED

#2  
REMOVE & DISPOSE OF SHIPPING PIN

#3  
INSERT THE AIR LINE INTO THE FITTING AND PRESS UNTIL FIRMLY SEATED

#4  
AIR LINE INSERTED

#5  
PULL AIR LINE OUTWARD TO LOCK AND ENSURE A SECURE CONNECTION